



WALDORF ASTORIA®
RESIDENCES
TEXAS • HILL COUNTRY

FLOOR PLANS



WALDORF ASTORIA®
RESIDENCES
TEXAS • HILL COUNTRY

RESORT VILLA
3 - BEDROOM

SIZE

3,197 AC SF
1,433 Non-AC SF
4,630 SF TOTAL

DETAILS

3 Bedrooms
3.5 Bathrooms

FEATURES

Study
Lock-Off Unit
Pool
Owner's Closet
Seamless Indoor/Outdoor Living
Optional Outdoor Showers
Optional Plunge Pool



Statement: We are pledged to the letter and spirit of U.S. policy for the achievement of equal housing throughout the nation. We encourage and support an affirmative advertising, marketing and sales program in which there are no barriers to obtaining housing because of race, color, sex, religion, handicap, familial status or national origin.

The materials, designs, features and amenities described or depicted by artist's or computer rendering are subject to change and no assurance is made that the project or the condominium units are of the same size or nature as depicted or described or that the project or the condominium units will be constructed. Certain features and finishes are not standard. Please consult with representatives of Lantana Land Holdings, LLC or its successors and assigns regarding the costs and availability of features and finishes in the project.

WARNING: THE CALIFORNIA DEPARTMENT OF REAL ESTATE HAS NOT EXAMINED THIS OFFERING, INCLUDING, BUT NOT LIMITED TO, THE CONDITION OF TITLE, THE STATUS OF BLANKET LIENS ON THE PROJECT (IF ANY), ARRANGEMENTS TO ASSURE PROJECT COMPLETION, ESCROW PRACTICES, CONTROL OVER PROJECT MANAGEMENT, RACIALLY DISCRIMINATORY PRACTICES (IF ANY), TERMS, CONDITIONS, AND PRICE OF THE OFFER, CONTROL OVER ANNUAL ASSESSMENTS (IF ANY), OR THE AVAILABILITY OF WATER, SERVICES, UTILITIES, OR IMPROVEMENTS. IT MAY BE ADVISABLE FOR YOU TO CONSULT AN ATTORNEY OR OTHER KNOWLEDGEABLE PROFESSIONAL WHO IS FAMILIAR WITH REAL ESTATE AND A LAW IN THE COUNTRY WHERE THIS SUBDIVISION IS SITUATED.

Resort Villas, Estates and Sunday Haus residences within The Villas at The Lantana Condominium and The Estates at The Lantana Condominium will be conveyed as an unimproved condominium unit. No residential improvements will be included within the unit. All residential improvements must be constructed by the owner pursuant to approved plans and utilizing an approved builder at the owner's sole cost and expense. Unless expressly provided for in the purchase contract, the condominium units will be sold unfurnished, regardless of any furniture shown in the images presented herein. Certain features and finishes are not standard. Floor plans shown are not to any particular scale and are subject to change. All dimensions and square footages are approximate, are subject to change, and are measured using the outside of the stud wall, which dimensions may vary from the description and definition of the "residence" and "unit" as set forth in the purchase contract and which will be conveyed.

Waldorf Astoria is a registered trademark of Hilton International Holding LLC, an affiliate of Hilton Worldwide Holdings Inc. (together with its affiliates, "Hilton"). The Waldorf Astoria Residences Texas Hill Country and Waldorf Astoria Resort Villas Texas Hill Country (the "Residences") are not owned, developed or sold by Hilton, and Hilton does not make any representations, warranties or guaranties whatsoever with respect to the Residences or related development. Wine Country Hospitality Partners, LLC ("Developer") uses the Waldorf Astoria brand name and certain Waldorf Astoria trademarks (the "Trademarks") under a limited, non-exclusive, non-transferable license from Hilton. The license may be terminated or may expire without renewal, in which case the Residences will not be identified as a Waldorf Astoria branded project and the Developer will not have any rights to use the Trademarks.



WALDORF ASTORIA®
RESIDENCES
TEXAS • HILL COUNTRY

RESORT VILLA
4 - BEDROOM

SIZE

3,420 AC SF

1,352 Non-AC SF

4,772 SF TOTAL

DETAILS

4 Bedrooms

4.5 Bathrooms

FEATURES

Lock-Off Unit

Pool

Owner's Closet

Seamless Indoor/Outdoor Living

Optional Outdoor Showers

Optional Plunge Pool

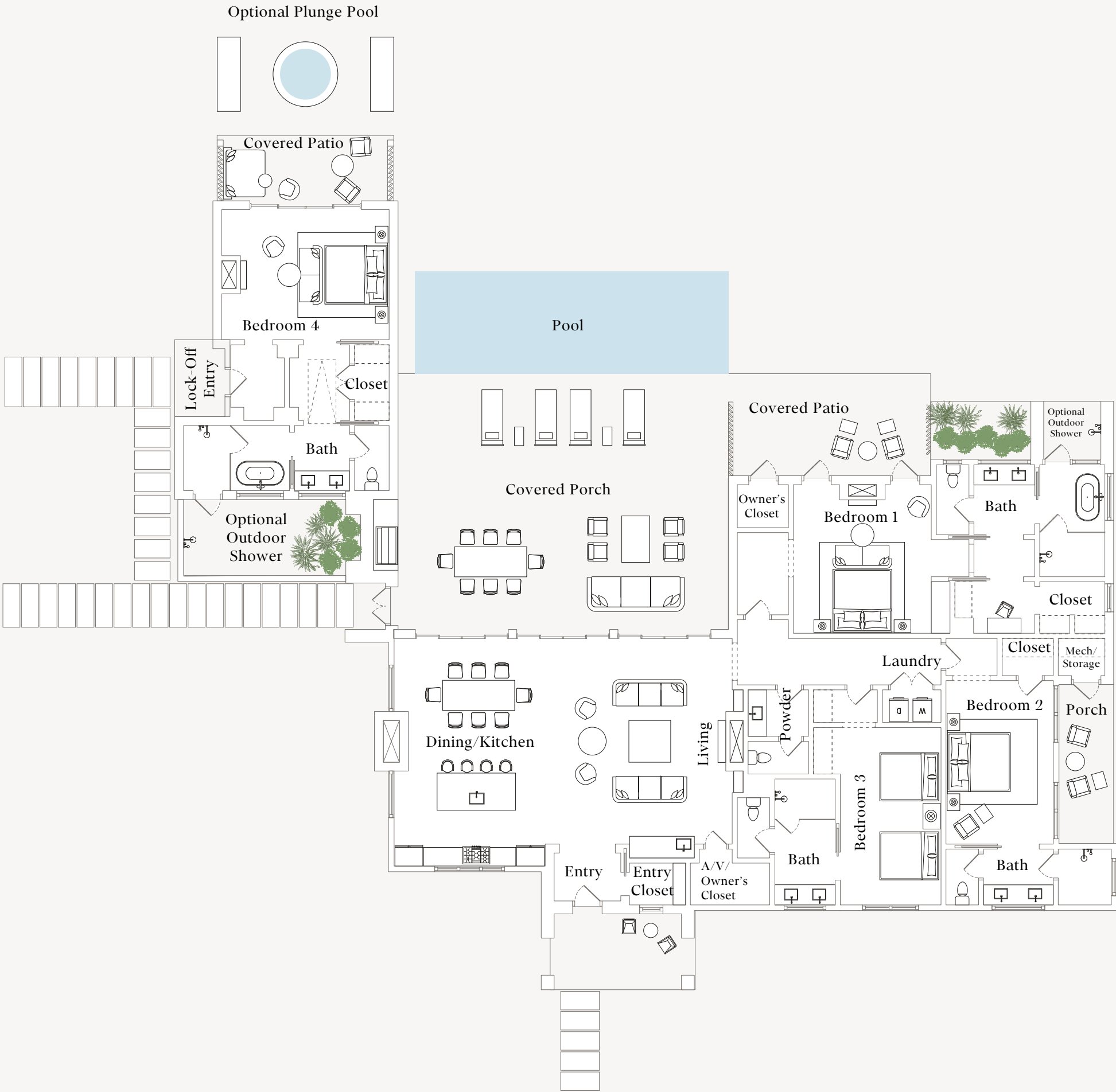

Statement: We are pledged to the letter and spirit of U.S. policy for the achievement of equal housing throughout the nation. We encourage and support an affirmative advertising, marketing and sales program in which there are no barriers to obtaining housing because of race, color, sex, religion, handicap, familial status or national origin.

The materials, designs, features and amenities described or depicted by artist's or computer rendering are subject to change and no assurance is made that the project or the condominium units are of the same size or nature as depicted or described or that the project or the condominium units will be constructed. Certain features and finishes are not standard. Please consult with representatives of Lantana Land Holdings, LLC or its successors and assigns regarding the costs and availability of features and finishes in the project.

WARNING: THE CALIFORNIA DEPARTMENT OF REAL ESTATE HAS NOT EXAMINED THIS OFFERING, INCLUDING, BUT NOT LIMITED TO, THE CONDITION OF TITLE, THE STATUS OF BLANKET LIENS ON THE PROJECT (IF ANY), ARRANGEMENTS TO ASSURE PROJECT COMPLETION, ESCROW PRACTICES, CONTROL OVER PROJECT MANAGEMENT, RACIALLY DISCRIMINATORY PRACTICES (IF ANY), TERMS, CONDITIONS, AND PRICE OF THE OFFER, CONTROL OVER ANNUAL ASSESSMENTS (IF ANY), OR THE AVAILABILITY OF WATER, SERVICES, UTILITIES, OR IMPROVEMENTS. IT MAY BE ADVISABLE FOR YOU TO CONSULT AN ATTORNEY OR OTHER KNOWLEDGEABLE PROFESSIONAL WHO IS FAMILIAR WITH REAL ESTATE AND A LAW IN THE COUNTRY WHERE THIS SUBDIVISION IS SITUATED.

Resort Villas, Estates and Sunday Haus residences within The Villas at The Lantana Condominium and The Estates at The Lantana Condominium will be conveyed as an unimproved condominium unit. No residential improvements will be included within the unit. All residential improvements must be constructed by the owner pursuant to approved plans and utilizing an approved builder at the owner's sole cost and expense. Unless expressly provided for in the purchase contract, the condominium units will be sold unfurnished, regardless of any furniture shown in the images presented herein. Certain features and finishes are not standard. Floor plans shown are not to any particular scale and are subject to change. All dimensions and square footages are approximate, are subject to change, and are measured using the outside of the stud wall, which dimensions may vary from the description and definition of the "residence" and "unit" as set forth in the purchase contract and which will be conveyed.

Waldorf Astoria is a registered trademark of Hilton International Holding LLC, an affiliate of Hilton Worldwide Holdings Inc. (together with its affiliates, "Hilton"). The Waldorf Astoria Residences Texas Hill Country and Waldorf Astoria Resort Villas Texas Hill Country (the "Residences") are not owned, developed or sold by Hilton, and Hilton does not make any representations, warranties or guaranties whatsoever with respect to the Residences or related development. Wine Country Hospitality Partners, LLC ("Developer") uses the Waldorf Astoria brand name and certain Waldorf Astoria trademarks (the "Trademarks") under a limited, non-exclusive, non-transferable license from Hilton. The license may be terminated or may expire without renewal, in which case the Residences will not be identified as a Waldorf Astoria branded project and the Developer will not have any rights to use the Trademarks.

BLUEBELL
ESTATE PLAN

SIZE

3,210 AC SF

1,253 Non-AC SF

4,464 SF TOTAL

DETAILS

3 Bedrooms

3.5 Bathrooms

1 Flex Room

FEATURES

Study

Wine Room

Wine Porch

Flex Room w/ Optional J&J Bath

Butler’s Pantry

Seamless Indoor / Outdoor Living

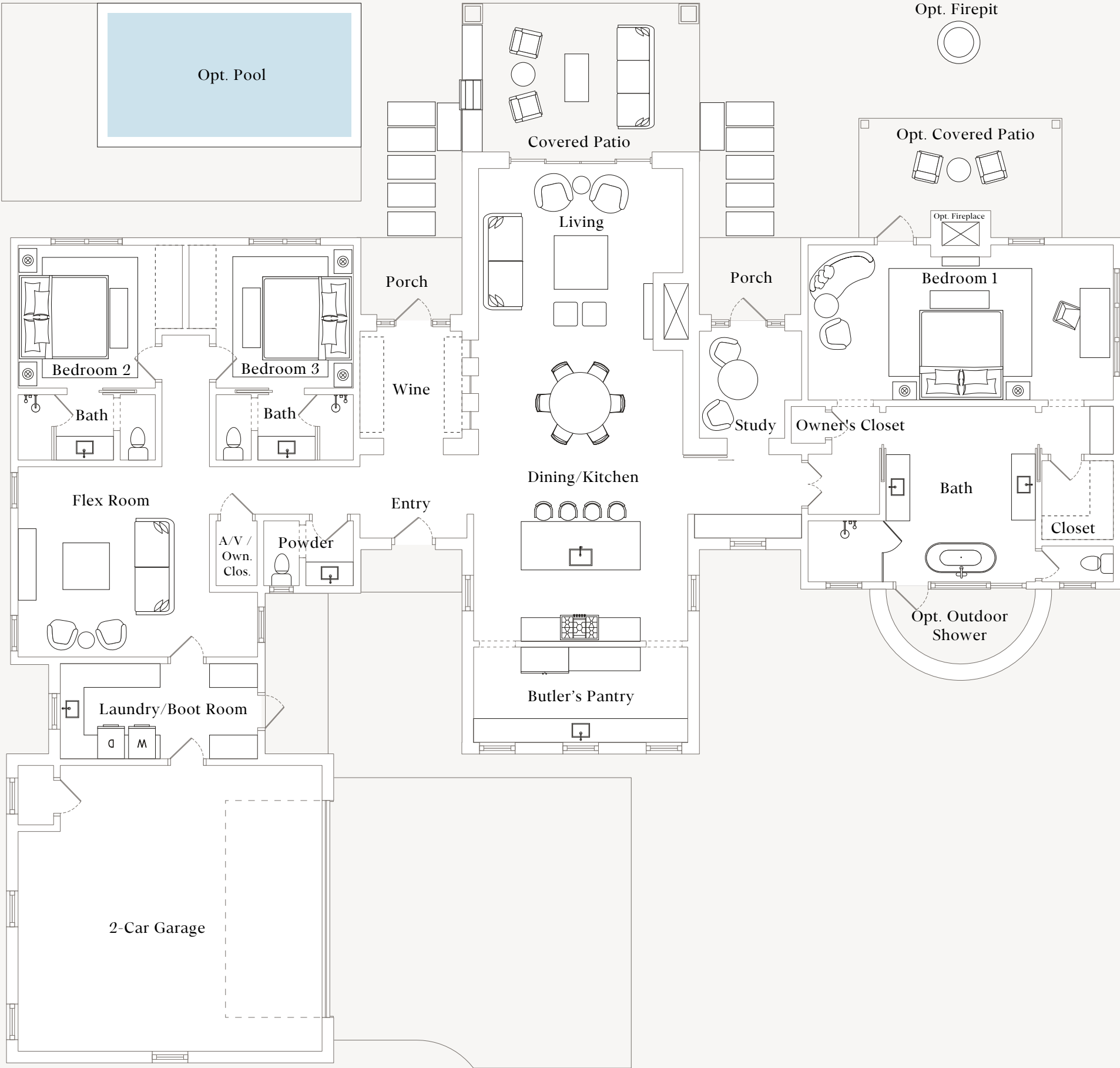

Statement: We are pledged to the letter and spirit of U.S. policy for the achievement of equal housing throughout the nation. We encourage and support an affirmative advertising, marketing and sales program in which there are no barriers to obtaining housing because of race, color, sex, religion, handicap, familial status or national origin.

The materials, designs, features and amenities described or depicted by artist's or computer rendering are subject to change and no assurance is made that the project or the condominium units are of the same size or nature as depicted or described or that the project or the condominium units will be constructed. Certain features and finishes are not standard. Please consult with representatives of Lantana Land Holdings, LLC or its successors and assigns regarding the costs and availability of features and finishes in the project.

WARNING: THE CALIFORNIA DEPARTMENT OF REAL ESTATE HAS NOT EXAMINED THIS OFFERING, INCLUDING, BUT NOT LIMITED TO, THE CONDITION OF TITLE, THE STATUS OF BLANKET LIENS ON THE PROJECT (IF ANY), ARRANGEMENTS TO ASSURE PROJECT COMPLETION, ESCROW PRACTICES, CONTROL OVER PROJECT MANAGEMENT, RACIALLY DISCRIMINATORY PRACTICES (IF ANY), TERMS, CONDITIONS, AND PRICE OF THE OFFER, CONTROL OVER ANNUAL ASSESSMENTS (IF ANY), OR THE AVAILABILITY OF WATER, SERVICES, UTILITIES, OR IMPROVEMENTS. IT MAY BE ADVISABLE FOR YOU TO CONSULT AN ATTORNEY OR OTHER KNOWLEDGEABLE PROFESSIONAL WHO IS FAMILIAR WITH REAL ESTATE AND A LAW IN THE COUNTRY WHERE THIS SUBDIVISION IS SITUATED.

Resort Villas, Estates and Sunday Haus residences within The Villas at The Lantana Condominium and The Estates at The Lantana Condominium will be conveyed as an unimproved condominium unit. No residential improvements will be included within the unit. All residential improvements must be constructed by the owner pursuant to approved plans and utilizing an approved builder at the owner's sole cost and expense. Unless expressly provided for in the purchase contract, the condominium units will be sold unfurnished, regardless of any furniture shown in the images presented herein. Certain features and finishes are not standard. Floor plans shown are not to any particular scale and are subject to change. All dimensions and square footages are approximate, are subject to change, and are measured using the outside of the stud wall, which dimensions may vary from the description and definition of the "residence" and "unit" as set forth in the purchase contract and which will be conveyed.

Waldorf Astoria is a registered trademark of Hilton International Holding LLC, an affiliate of Hilton Worldwide Holdings Inc. (together with its affiliates, "Hilton"). The Waldorf Astoria Residences Texas Hill Country and Waldorf Astoria Resort Villas Texas Hill Country (the "Residences") are not owned, developed or sold by Hilton, and Hilton does not make any representations, warranties or guaranties whatsoever with respect to the Residences or related development. Wine Country Hospitality Partners, LLC ("Developer") uses the Waldorf Astoria brand name and certain Waldorf Astoria trademarks (the "Trademarks") under a limited, non-exclusive, non-transferable license from Hilton. The license may be terminated or may expire without renewal, in which case the Residences will not be identified as a Waldorf Astoria branded project and the Developer will not have any rights to use the Trademarks.



BLUEBONNET

ESTATE PLAN

SIZE

3,499 AC SF

1,263 Non-AC SF

4,763 SF TOTAL

DETAILS

3 Bedrooms

4.5 Bathrooms

1 Flex Room

FEATURES

Courtyard Focused

Study

Wine Room

Flex Room

Seamless Indoor/Outdoor Living

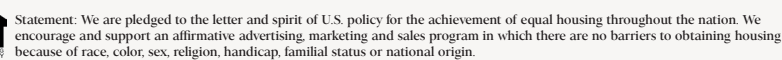
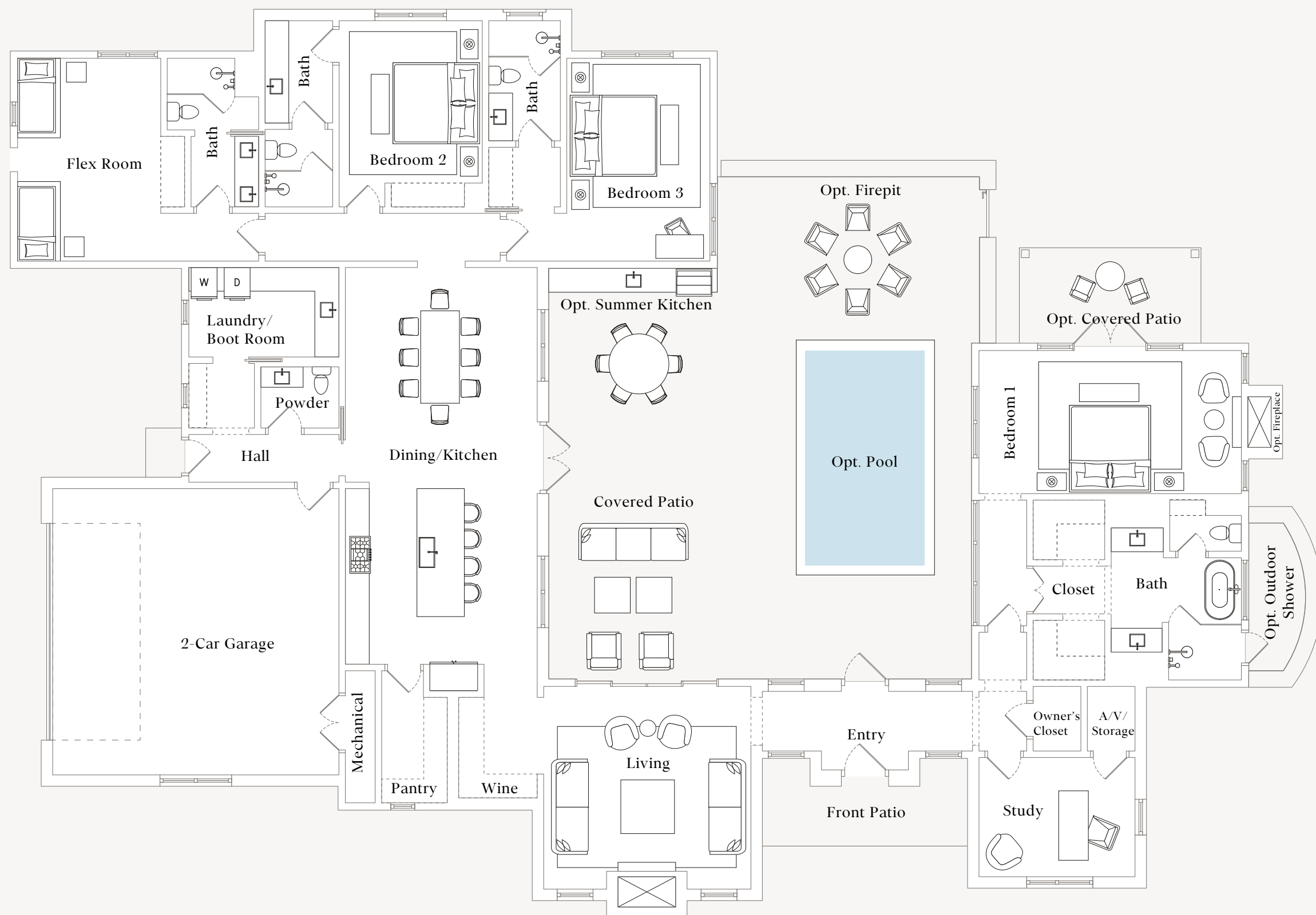

The materials, designs, features and amenities described or depicted by artist's or computer rendering are subject to change and no assurance is made that the project or the condominium units are of the same size or nature as depicted or described or that the project or the condominium units will be constructed. Certain features and finishes are not standard. Please consult with representatives of Lantana Land Holdings, LLC or its successors and assigns regarding the costs and availability of features and finishes in the project.

WARNING: THE CALIFORNIA DEPARTMENT OF REAL ESTATE HAS NOT EXAMINED THIS OFFERING, INCLUDING, BUT NOT LIMITED TO, THE CONDITION OF TITLE, THE STATUS OF BLANKET LIENS ON THE PROJECT (IF ANY), ARRANGEMENTS TO ASSURE PROJECT COMPLETION, ESCROW PRACTICES, CONTROL OVER PROJECT MANAGEMENT, RACIALLY DISCRIMINATORY PRACTICES (IF ANY), TERMS, CONDITIONS, AND PRICE OF THE OFFER, CONTROL OVER ANNUAL ASSESSMENTS (IF ANY), OR THE AVAILABILITY OF WATER, SERVICES, UTILITIES, OR IMPROVEMENTS. IT MAY BE ADVISABLE FOR YOU TO CONSULT AN ATTORNEY OR OTHER KNOWLEDGEABLE PROFESSIONAL WHO IS FAMILIAR WITH REAL ESTATE AND A LAW IN THE COUNTRY WHERE THIS SUBDIVISION IS SITUATED.

Resort Villas, Estates and Sunday Haus residences within The Villas at The Lantana Condominium and The Estates at The Lantana Condominium will be conveyed as an unimproved condominium unit. No residential improvements will be included within the unit. All residential improvements must be constructed by the owner pursuant to approved plans and utilizing an approved builder at the owner's sole cost and expense. Unless expressly provided for in the purchase contract, the condominium units will be sold unfurnished, regardless of any furniture shown in the images presented herein. Certain features and finishes are not standard. Floor plans shown are not to any particular scale and are subject to change. All dimensions and square footages are approximate, are subject to change, and are measured using the outside of the stud wall, which dimensions may vary from the description and definition of the "residence" and "unit" as set forth in the purchase contract and which will be conveyed.

Waldorf Astoria is a registered trademark of Hilton International Holding LLC, an affiliate of Hilton Worldwide Holdings Inc. (together with its affiliates, "Hilton"). The Waldorf Astoria Residences Texas Hill County and Waldorf Astoria Resort Villas Texas Hill Country (the "Residences") are not owned, developed or sold by Hilton, and Hilton does not make any representations, warranties or guarantees whatsoever with respect to the Residences or related development. Wine Country Hospitality Partners, LLC ("Developer") uses the Waldorf Astoria brand name and certain Waldorf Astoria trademarks (the "Trademarks") under a limited, non-exclusive, non-transferable license from Hilton. The license may be terminated or may expire without renewal, in which case the Residences will not be identified as a Waldorf Astoria branded project and the Developer will not have any rights to use the Trademarks.



SIZE

3,978 AC SF

1,398 Non-AC SF

5,376 SF TOTAL

DETAILS

4 Bedrooms

4.5 Bathrooms

FEATURES

Courtyard Focused

Study

Wine Room

Large Utility/Boot Room

Primary Lounge w/ Coffee Bar

Option for Summer Kitchen

Seamless Indoor/Outdoor Living

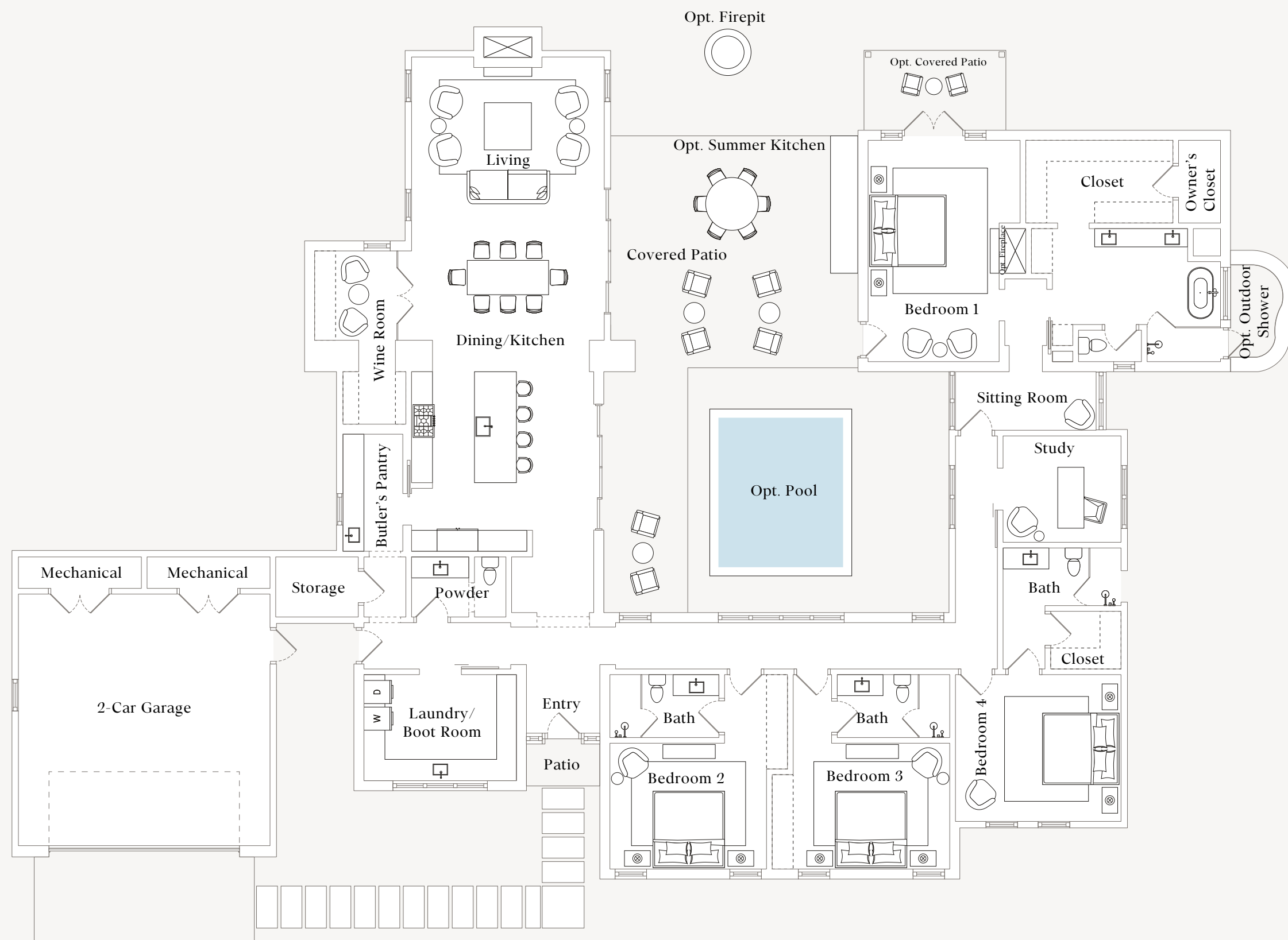

Statement: We are pledged to the letter and spirit of U.S. policy for the achievement of equal housing throughout the nation. We encourage and support an affirmative advertising, marketing and sales program in which there are no barriers to obtaining housing because of race, color, sex, religion, handicap, familial status or national origin.

The materials, designs, features and amenities described or depicted by artist's or computer rendering are subject to change and no assurance is made that the project or the condominium units are of the same size or nature as depicted or described or that the project or the condominium units will be constructed. Certain features and finishes are not standard. Please consult with representatives of Lantana Land Holdings, LLC or its successors and assigns regarding the costs and availability of features and finishes in the project.

WARNING: THE CALIFORNIA DEPARTMENT OF REAL ESTATE HAS NOT EXAMINED THIS OFFERING, INCLUDING, BUT NOT LIMITED TO, THE CONDITION OF TITLE, THE STATUS OF BLANKET LIENS ON THE PROJECT (IF ANY), ARRANGEMENTS TO ASSURE PROJECT COMPLETION, ESCROW PRACTICES, CONTROL OVER PROJECT MANAGEMENT, RACIALLY DISCRIMINATORY PRACTICES (IF ANY), TERMS, CONDITIONS, AND PRICE OF THE OFFER, CONTROL OVER ANNUAL ASSESSMENTS (IF ANY), OR THE AVAILABILITY OF WATER, SERVICES, UTILITIES, OR IMPROVEMENTS. IT MAY BE ADVISABLE FOR YOU TO CONSULT AN ATTORNEY OR OTHER KNOWLEDGEABLE PROFESSIONAL WHO IS FAMILIAR WITH REAL ESTATE AND A LAW IN THE COUNTRY WHERE THIS SUBDIVISION IS SITUATED.

Resort Villas, Estates and Sunday Haus residences within The Villas at The Lantana Condominium and The Estates at The Lantana Condominium will be conveyed as an unimproved condominium unit. No residential improvements will be included within the unit. All residential improvements must be constructed by the owner pursuant to approved plans and utilizing an approved builder at the owner's sole cost and expense. Unless expressly provided for in the purchase contract, the condominium units will be sold unfurnished, regardless of any furniture shown in the images presented herein. Certain features and finishes are not standard. Floor plans shown are not to any particular scale and are subject to change. All dimensions and square footages are approximate, are subject to change, and are measured using the outside of the stud wall, which dimensions may vary from the description and definition of the "residence" and "unit" as set forth in the purchase contract and which will be conveyed.

Waldorf Astoria is a registered trademark of Hilton International Holding LLC, an affiliate of Hilton Worldwide Holdings Inc. (together with its affiliates, "Hilton"). The Waldorf Astoria Residences Texas Hill County and Waldorf Astoria Resort Villas Texas Hill Country (the "Residences") are not owned, developed or sold by Hilton, and Hilton does not make any representations, warranties or guarantees whatsoever with respect to the Residences or related development. Wine Country Hospitality Partners, LLC ("Developer") uses the Waldorf Astoria brand name and certain Waldorf Astoria trademarks (the "Trademarks") under a limited, non-exclusive, non-transferable license from Hilton. The license may be terminated or may expire without renewal, in which case the Residences will not be identified as a Waldorf Astoria branded project and the Developer will not have any rights to use the Trademarks.



FOXGLOVE

ESTATE PLAN

SIZE

4,384 AC SF

1,908 Non-AC SF

6,292 SF TOTAL

DETAILS

4 Bedrooms

4.5 Bathrooms

FEATURES

Courtyard Focused

Detached Study

Wine Room

Bar Area

Seamless Indoor/Outdoor Living

Primary Lounge

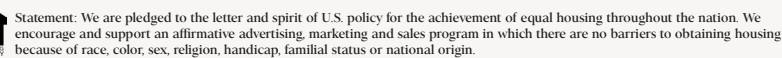
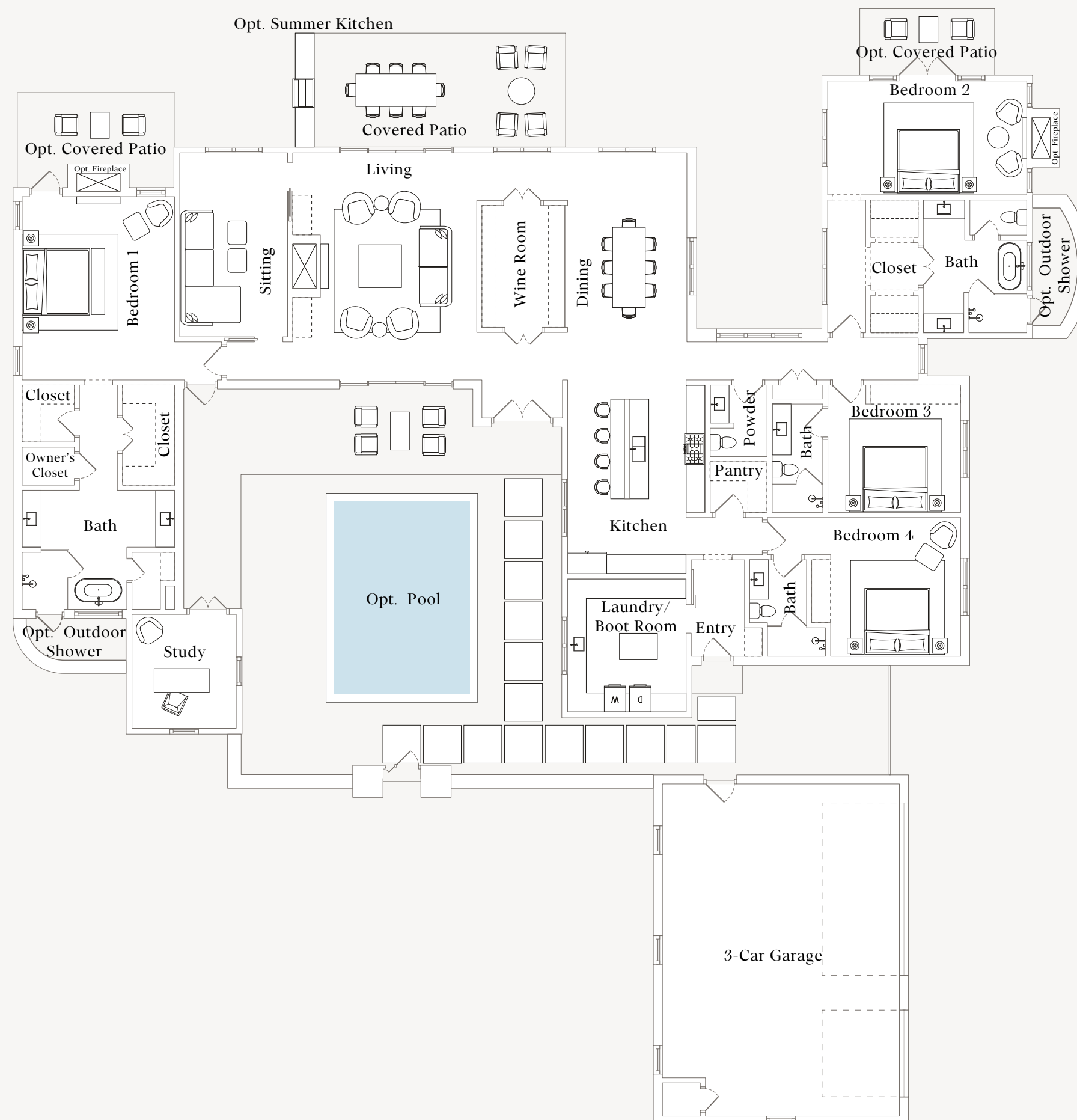

The materials, designs, features and amenities described or depicted by artist's or computer rendering are subject to change and no assurance is made that the project or the condominium units are of the same size or nature as depicted or described or that the project or the condominium units will be constructed. Certain features and finishes are not standard. Please consult with representatives of Lantana Land Holdings, LLC or its successors and assigns regarding the costs and availability of features and finishes in the project.

WARNING: THE CALIFORNIA DEPARTMENT OF REAL ESTATE HAS NOT EXAMINED THIS OFFERING, INCLUDING, BUT NOT LIMITED TO, THE CONDITION OF TITLE, THE STATUS OF BLANKET LIENS ON THE PROJECT (IF ANY), ARRANGEMENTS TO ASSURE PROJECT COMPLETION, ESCROW PRACTICES, CONTROL OVER PROJECT MANAGEMENT, RACIALLY DISCRIMINATORY PRACTICES (IF ANY), TERMS, CONDITIONS, AND PRICE OF THE OFFER, CONTROL OVER ANNUAL ASSESSMENTS (IF ANY), OR THE AVAILABILITY OF WATER, SERVICES, UTILITIES, OR IMPROVEMENTS. IT MAY BE ADVISABLE FOR YOU TO CONSULT AN ATTORNEY OR OTHER KNOWLEDGEABLE PROFESSIONAL WHO IS FAMILIAR WITH REAL ESTATE AND A LAW IN THE COUNTRY WHERE THIS SUBDIVISION IS SITUATED.

Resort Villas, Estates and Sunday Haus residences within The Villas at The Lantana Condominium and The Estates at The Lantana Condominium will be conveyed as an unimproved condominium unit. No residential improvements will be included within the unit. All residential improvements must be constructed by the owner pursuant to approved plans and utilizing an approved builder at the owner's sole cost and expense. Unless expressly provided for in the purchase contract, the condominium units will be sold unfurnished, regardless of any furniture shown in the images presented herein. Certain features and finishes are not standard. Floor plans shown are not to any particular scale and are subject to change. All dimensions and square footages are approximate, are subject to change, and are measured using the outside of the stud wall, which dimensions may vary from the description and definition of the "residence" and "unit" as set forth in the purchase contract and which will be conveyed.

Waldorf Astoria is a registered trademark of Hilton International Holding LLC, an affiliate of Hilton Worldwide Holdings Inc. (together with its affiliates, "Hilton"). The Waldorf Astoria Residences Texas Hill Country and Waldorf Astoria Resort Villas Texas Hill Country (the "Residences") are not owned, developed or sold by Hilton, and Hilton does not make any representations, warranties or guarantees whatsoever with respect to the Residences or related development. Wine Country Hospitality Partners, LLC ("Developer") uses the Waldorf Astoria brand name and certain Waldorf Astoria trademarks (the "Trademarks") under a limited, non-exclusive, non-transferable license from Hilton. The license may be terminated or may expire without renewal, in which case the Residences will not be identified as a Waldorf Astoria branded project and the Developer will not have any rights to use the Trademarks.



SIZE

1,537 Non-AC SF

4,936 SF TOTAL

DETAILS

3 Bedrooms

4.5 Bathrooms

1 Flex Room

FEATURES

Study

Wine Room

Flex Room with Ensuite

Seamless Indoor/Outdoor Living

Large Covered Patio

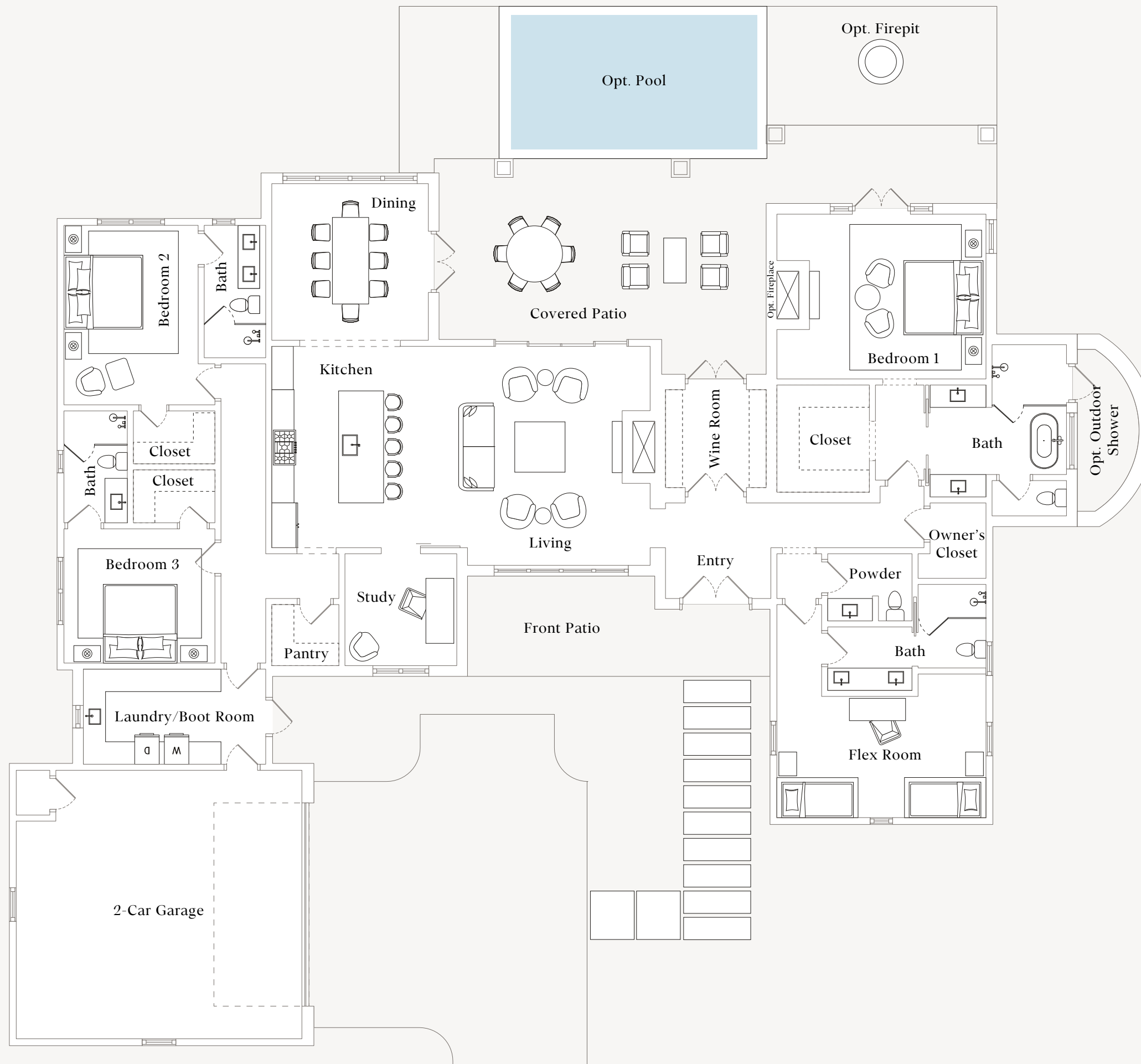

Statement: We are pledged to the letter and spirit of U.S. policy for the achievement of equal housing throughout the nation. We encourage and support an affirmative advertising, marketing and sales program in which there are no barriers to obtaining housing because of race, color, sex, religion, handicap, familial status or national origin.

The materials, designs, features and amenities described or depicted by artist's or computer rendering are subject to change and no assurance is made that the project or the condominium units are of the same size or nature as depicted or described or that the project or the condominium units will be constructed. Certain features and finishes are not standard. Please consult with representatives of Lantana Land Holdings, LLC or its successors and assigns regarding the costs and availability of features and finishes in the project.

WARNING: THE CALIFORNIA DEPARTMENT OF REAL ESTATE HAS NOT EXAMINED THIS OFFERING, INCLUDING, BUT NOT LIMITED TO, THE CONDITION OF TITLE, THE STATUS OF BLANKET LIENS ON THE PROJECT (IF ANY), ARRANGEMENTS TO ASSURE PROJECT COMPLETION, ESCROW PRACTICES, CONTROL OVER PROJECT MANAGEMENT, RACIALLY DISCRIMINATORY PRACTICES (IF ANY), TERMS, CONDITIONS, AND PRICE OF THE OFFER, CONTROL OVER ANNUAL ASSESSMENTS (IF ANY), OR THE AVAILABILITY OF WATER, SERVICES, UTILITIES, OR IMPROVEMENTS. IT MAY BE ADVISABLE FOR YOU TO CONSULT AN ATTORNEY OR OTHER KNOWLEDGEABLE PROFESSIONAL WHO IS FAMILIAR WITH REAL ESTATE AND A LAW IN THE COUNTRY WHERE THIS SUBDIVISION IS SITUATED.

Resort Villas, Estates and Sunday Haus residences within The Villas at The Lantana Condominium and The Estates at The Lantana Condominium will be conveyed as an unimproved condominium unit. No residential improvements will be included within the unit. All residential improvements must be constructed by the owner pursuant to approved plans and utilizing an approved builder at the owner's sole cost and expense. Unless expressly provided for in the purchase contract, the condominium units will be sold unfurnished, regardless of any furniture shown in the images presented herein. Certain features and finishes are not standard. Floor plans shown are not to any particular scale and are subject to change. All dimensions and square footages are approximate, are subject to change, and are measured using the outside of the stud wall, which dimensions may vary from the description and definition of the "residence" and "unit" as set forth in the purchase contract and which will be conveyed.

Waldorf Astoria is a registered trademark of Hilton International Holding LLC, an affiliate of Hilton Worldwide Holdings Inc. (together with its affiliates, "Hilton"). The Waldorf Astoria Residences Texas Hill County and Waldorf Astoria Resort Villas Texas Hill Country (the "Residences") are not owned, developed or sold by Hilton, and Hilton does not make any representations, warranties or guarantees whatsoever with respect to the Residences or related development. Wine Country Hospitality Partners, LLC ("Developer") uses the Waldorf Astoria brand name and certain Waldorf Astoria trademarks (the "Trademarks") under a limited, non-exclusive, non-transferable license from Hilton. The license may be terminated or may expire without renewal, in which case the Residences will not be identified as a Waldorf Astoria branded project and the Developer will not have any rights to use the Trademarks.



SIZE

2,656 AC

1,153 Non-AC

3,808 Total

DETAILS

3 Bedrooms

4.5 Bathrooms

FEATURES

Flex Room with Ensuite

Large Covered Patio

Owner's Closet

Two-Story Living

Garage & Covered Parking

Seamless Indoor/Outdoor Living

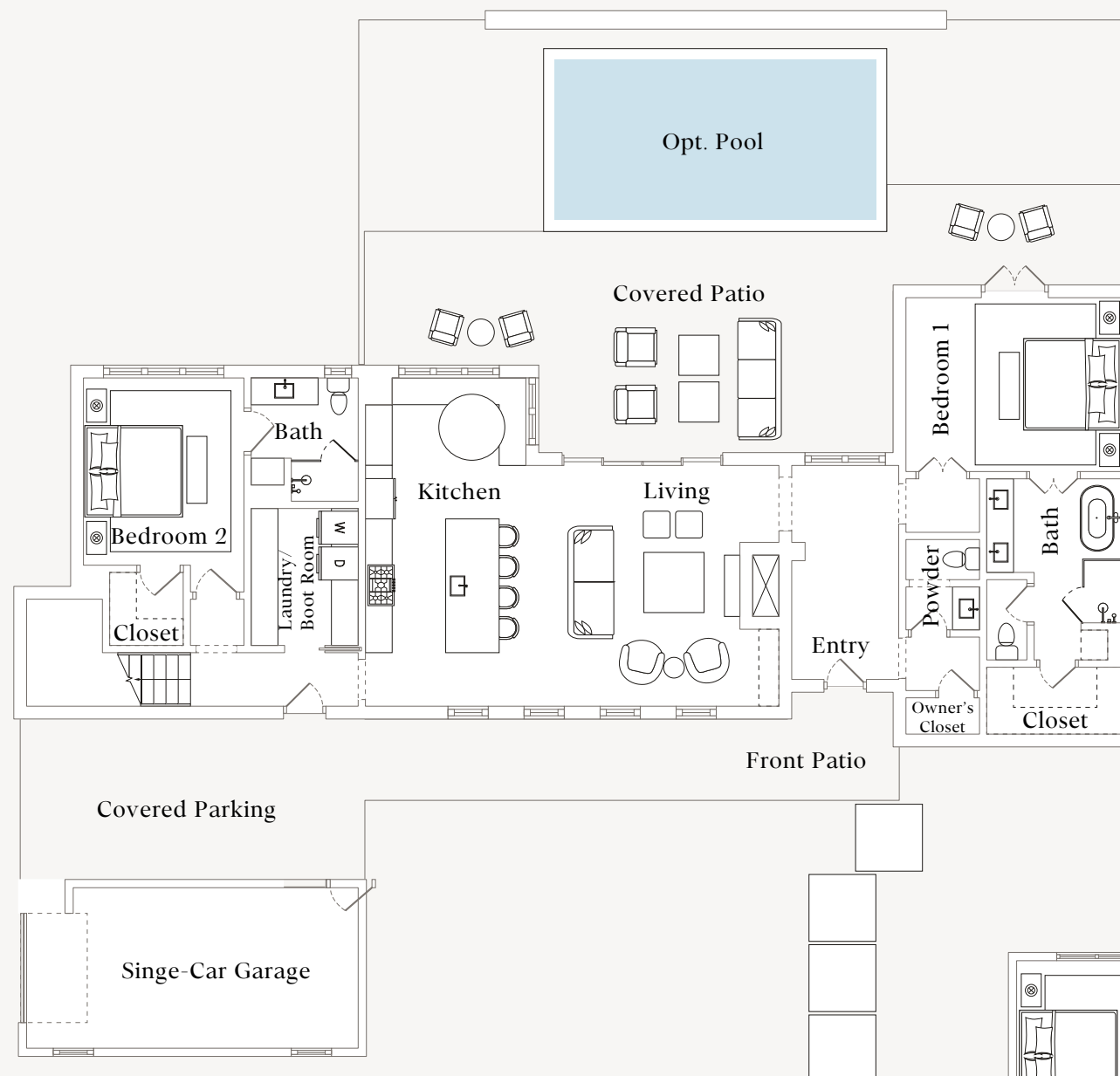

First Floor

Second Floor

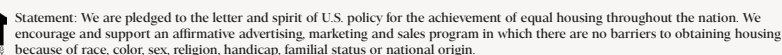
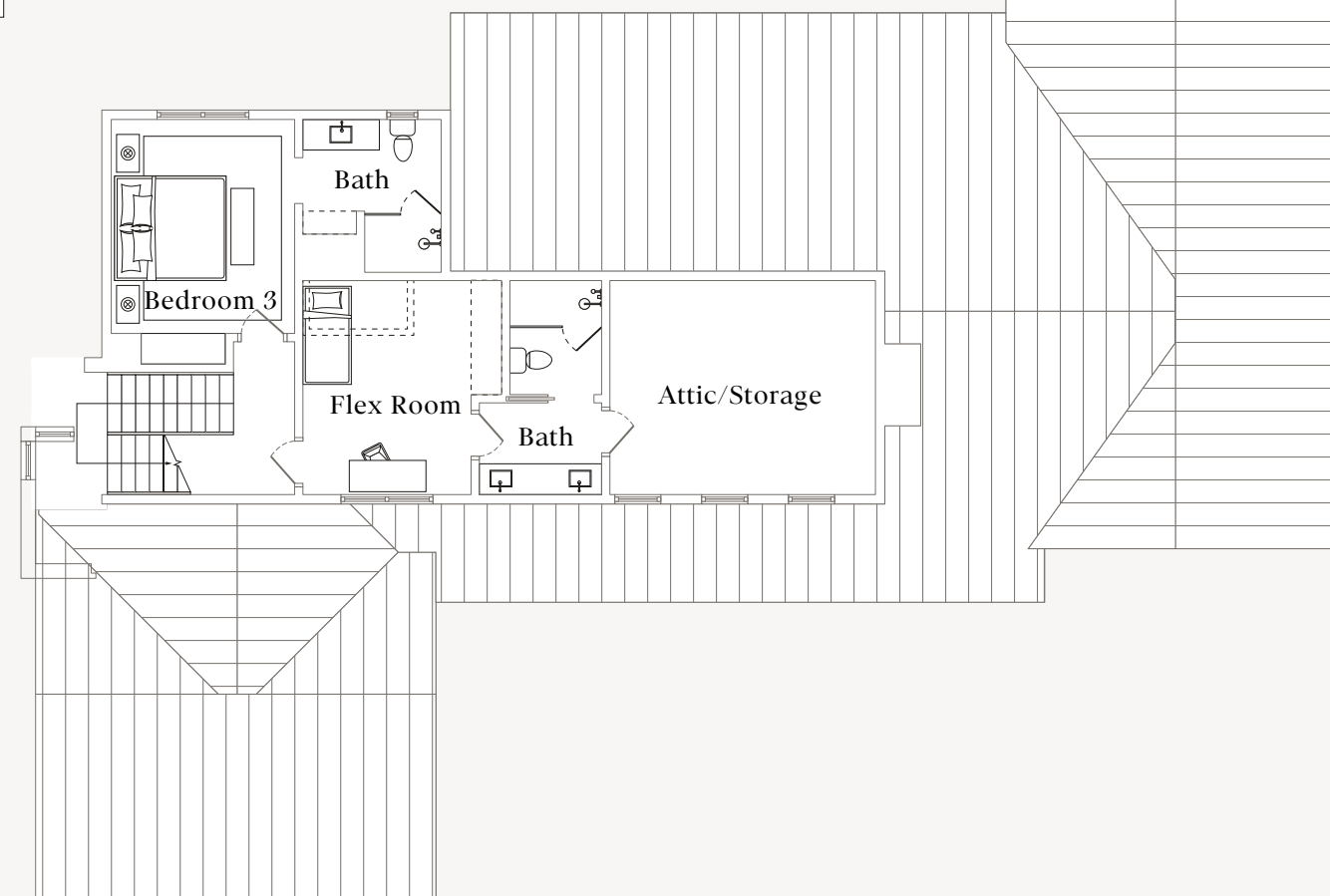

The materials, designs, features and amenities described or depicted by artist's or computer rendering are subject to change and no assurance is made that the project or the condominium units are of the same size or nature as depicted or described or that the project or the condominium units will be constructed. Certain features and finishes are not standard. Please consult with representatives of Lantana Land Holdings, LLC or its successors and assigns regarding the costs and availability of features and finishes in the project.

WARNING: THE CALIFORNIA DEPARTMENT OF REAL ESTATE HAS NOT EXAMINED THIS OFFERING, INCLUDING, BUT NOT LIMITED TO, THE CONDITION OF TITLE, THE STATUS OF BLANKET LIENS ON THE PROJECT (IF ANY), ARRANGEMENTS TO ASSURE PROJECT COMPLETION, ESCROW PRACTICES, CONTROL OVER PROJECT MANAGEMENT, RACIALLY DISCRIMINATORY PRACTICES (IF ANY), TERMS, CONDITIONS, AND PRICE OF THE OFFER, CONTROL OVER ANNUAL ASSESSMENTS (IF ANY), OR THE AVAILABILITY OF WATER, SERVICES, UTILITIES, OR IMPROVEMENTS. IT MAY BE ADVISABLE FOR YOU TO CONSULT AN ATTORNEY OR OTHER KNOWLEDGEABLE PROFESSIONAL WHO IS FAMILIAR WITH REAL ESTATE AND A LAW IN THE COUNTRY WHERE THIS SUBDIVISION IS SITUATED.

Resort Villas, Estates and Sunday Haus residences within The Villas at The Lantana Condominium and The Estates at The Lantana Condominium will be conveyed as an unimproved condominium unit. No residential improvements will be included within the unit. All residential improvements must be constructed by the owner pursuant to approved plans and utilizing an approved builder at the owner's sole cost and expense. Unless expressly provided for in the purchase contract, the condominium units will be sold unfurnished, regardless of any furniture shown in the images presented herein. Certain features and finishes are not standard. Floor plans shown are not to any particular scale and are subject to change. All dimensions and square footages are approximate, are subject to change, and are measured using the outside of the stud wall, which dimensions may vary from the description and definition of the "residence" and "unit" as set forth in the purchase contract and which will be conveyed.

Waldorf Astoria is a registered trademark of Hilton International Holding LLC, an affiliate of Hilton Worldwide Holdings Inc. (together with its affiliates, "Hilton"). The Waldorf Astoria Residences Texas Hill County and Waldorf Astoria Resort Villas Texas Hill Country (the "Residences") are not owned, developed or sold by Hilton, and Hilton does not make any representations, warranties or guarantees whatsoever with respect to the Residences or related development. Wine Country Hospitality Partners, LLC ("Developer") uses the Waldorf Astoria brand name and certain Waldorf Astoria trademarks (the "Trademarks") under a limited, non-exclusive, non-transferable license from Hilton. The license may be terminated or may expire without renewal, in which case the Residences will not be identified as a Waldorf Astoria branded project and the Developer will not have any rights to use the Trademarks.

(830) 888-9200

sales@WaldorfAstoriaResidencesTexasHillCountry.com

www.WaldorfAstoriaResidencesTexasHillCountry.com